

KIT DI CONNESSIONE DISPONIBILI

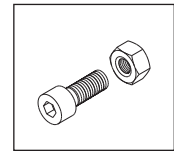
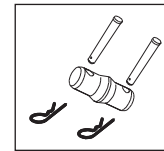

CARATTERISTICHE

Dimensioni esterne	292mm x 262 mm
Interasse	239 mm x 239 mm
Tubi correnti	Tubo tondo Ø 50x2 mm Alluminio EN AW 6082-T6
Tubi diagonali	Tubo tondo Ø 20x2 mm Alluminio EN AW 6060-T6
Flange	Fusione in Alluminio
Sistema di connessione	Set giunti con spine coniche e copiglie / bulloni (a richiesta)

MODULI STANDARD

LUNGH. (m)	0.21	0.50	1.00	1.50	2.00	2.50	3.00	3.50	4.00
PESO (kg)	-	4.1	6.1	8.1	10.2	12.2	14.3	16.3	18.3

Carichi (con giunti e spine)	CPL		2PL		3PL		4PL		UDL		Freccia Centrale Max.(cm)
	↓	↓	↓ ↓	↓ ↓ ↓	↓ ↓ ↓ ↓	↓ ↓ ↓ ↓ ↓	↓ ↓ ↓ ↓ ↓ ↓	↓ ↓ ↓ ↓ ↓ ↓ ↓ ↓	↓ ↓ ↓ ↓ ↓ ↓ ↓ ↓ ↓ ↓		
Lunghezza	↓	↓	↓ ↓	↓ ↓ ↓	↓ ↓ ↓ ↓	↓ ↓ ↓ ↓ ↓	↓ ↓ ↓ ↓ ↓ ↓	↓ ↓ ↓ ↓ ↓ ↓ ↓ ↓	↓ ↓ ↓ ↓ ↓ ↓ ↓ ↓ ↓ ↓	↓ ↓ ↓ ↓ ↓ ↓ ↓ ↓ ↓ ↓ ↓ ↓	
4 m	454	305	710	203	609	169	676	227	908	1.8	
6 m	293	198	396	132	396	110	440	97	582	4.1	
8 m	209	144	288	96	288	80	320	52	416	7.1	
10 m	156	109	218	73	219	61	244	31	310	10.9	
12 m	119	86	172	57	171	48	192	19	228	14.8	
14 m	91	68	136	45	135	38	152	13	182	20.2	
16 m	68	54	108	36	108	30	120	9	144	26.3	