

AVAILABLE COUPLING SETS

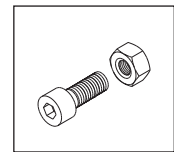
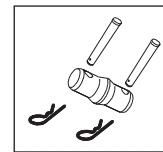

TECHNICAL SPECIFICATIONS

External dimensions	402 mm x 350 mm
Interaxis	350 mm x 350 mm
Main tube	Tube Ø 50x2 mm Aluminium EN AW 6082-T6
Diagonal tube	Tube Ø 25x2 mm Aluminium EN AW 6082-T6
Endplate	Casting Aluminium
Coupling set	Conical spigots, pins and clips (standard) / Bolts (on request)

Loading distribution WITH SPIGOTS	CPL		2PL		3PL		4PL		UDL		Max central Deflection (cm)
	↓	↓	↓ ↓	↓ ↓	↓ ↓	↓ ↓	↓ ↓	↓ ↓	U.D.L. (kg/m)	Total load weight (kg)	
Length	↓	↓	↓ ↓	↓ ↓	↓ ↓	↓ ↓	↓ ↓	↓ ↓			
4 m	576	432	864	288	864	240	960	288	1152	1.2	
6 m	376	282	564	188	564	157	628	125	750	2.6	
8 m	273	205	410	137	411	114	456	68	544	4.7	
10 m	210	157	314	105	315	87	348	42	420	7.3	
12 m	165	124	248	83	249	69	276	28	336	10.5	
14 m	133	99	198	66	198	55	220	19	196	14.3	
16 m	107	80	160	53	159	44	176	13	208	18.6	