

#### AVAILABLE COUPLING SETS

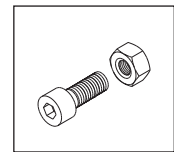
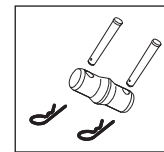

#### TECHNICAL SPECIFICATIONS

External dimensions	402 mm x 402 mm
Interaxis	350 mm x 350 mm
Main tube	Tube Ø 50x2 mm Aluminium EN AW 6082-T6
Diagonal tube	Tube Ø 25x2 mm Aluminium EN AW 6082-T6
Endplate	Casting Aluminium
Coupling set	Conical spigots, pins and clips (standard) / Bolts (on request)

#### STANDARD LENGTH

LENGTH (m)	0.50	1.00	1.50	2.00	2.50	3.00	3.50	4.00
WEIGHT (kg)	8.15	10.35	14.10	17.20	20.70	24.07	27.20	30.10

Loading distribution WITH SPIGOTS	CPL		2PL		3PL		4PL		UDL		Max central Deflection (cm)	
	↓	↓	↓ ↓	↓ ↓	↓ ↓	↓ ↓	↓ ↓	↓ ↓	↓ ↓			
Length	↓	↓	↓ ↓	↓	↓ ↓	↓	↓ ↓	↓	↓ ↓	U.D.L. (kg/m)	Total load weight (kg)	Max central Deflection (cm)
4 m	1050	850	1700	560	1680	420	1680	640	2560	1.4		
6 m	843	632	1264	421	1263	351	1404	281	1686	2.8		
8 m	618	464	928	309	927	258	1032	155	1240	5.7		
10 m	480	360	720	240	720	200	800	96	960	8.9		
12 m	385	289	578	193	579	161	644	64	768	12.8		
14 m	315	237	474	158	474	131	524	45	630	17.7		
16 m	261	196	392	131	393	109	436	30	480	22.0		