

AVAILABLE COUPLING SETS

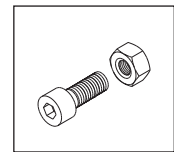
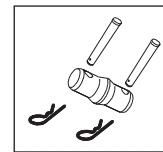

TECHNICAL SPECIFICATIONS

External dimensions	402 mm x 52 mm
Interaxis	350 mm
Main tube	Tube Ø 50x2 mm Aluminium EN AW 6082-T6
Diagonal tube	Tube Ø 25x2 mm Aluminium EN AW 6082-T6
Endplate	Casting Aluminium
Coupling set	Conical spigots, pins and clips (standard) / Bolts (on request)

STANDARD LENGTH

LENGTH (m)	0.50	1.00	1.50	2.00	2.50	3.00	3.50	4.00
WEIGHT (kg)	4.0	5.0	7.0	8.5	10.0	12.0	13.0	15.0

Loading distribution WITH SPIGOTS	CPL		2PL		3PL		4PL		UDL		
Length	↓	↓	↓↓	↓	↓↓	↓	↓↓	U.D.L. (kg/m)	Total load weight (kg)	Max central Deflection (cm)	
4 m	308	231	462	154	462	128	512	154	616	0,6	
6 m	200	150	300	100	300	83	332	67	402	1,4	
8 m	144	108	216	72	216	60	240	36	288	2,5	
10 m	109	81	162	54	162	45	180	22	220	3,9	
12 m	84	63	126	42	126	35	140	14	168	5,6	