

AVAILABLE CONNECTION SYSTEMS

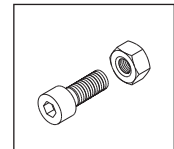
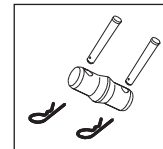

TECHNICAL SPECIFICATIONS

External dimensions	292mm x 52 mm
Interaxis	239 mm
Main tube	Round tube Ø 50x2 mm Aluminium EN AW 6082-T6
Diagonal tube	Round tube Ø 20x2 mm Aluminium EN AW 6060-T6
Endplate	Casting Aluminium
Coupling set	Conical spigots, pins and clips (standard) / Bolts (on request)

STANDARD LENGTHS

LENGTH (m)	0.21	0.50	1.00	1.50	2.00	2.50	3.00	3.50	4.00
WEIGHT (kg)	-	2.5	3.8	5.0	6.2	7.5	8.7	9.9	11.0

Loading distribution WITH SPIGOTS	CPL		2PL		3PL		4PL		UDL		
Length	↓	↓	↓↓	↓	↓↓	↓	↓↓	U.D.L. (kg/m)	Total load weight (kg)	Max central Deflection (cm)	
4 m	220	171	342	114	342	95	380	110	440	0.9	
6 m	145	117	234	78	234	65	260	48	288	2.1	
8 m	105	90	180	60	180	50	200	26	208	3.8	
10 m	80	75	150	50	150	42	168	16	160	6.2	
12 m	64	68	136	45	135	38	152	11	132	9.6	